

Polaris D'Light Bulb for Portable Spas

WARNING: RISK OF ELECTRICAL SHOCK. Disconnect from power before performing maintenance or repairs. Avoid contact with electrical voltage and do not handle with wet feet or hands.

Before installation, check voltage of existing light assembly to ensure it matches the voltage of the new Polaris D'Light®. Polaris D'Light fits bi-pin wedge sockets using 12 VAC bulbs.

Installation

1. Turn OFF power.
2. Detach light casing from lens fixture at spa wall. As some spas use clamps, screws or snap assemblies, refer to the original spa manufacturer's manual for instructions.

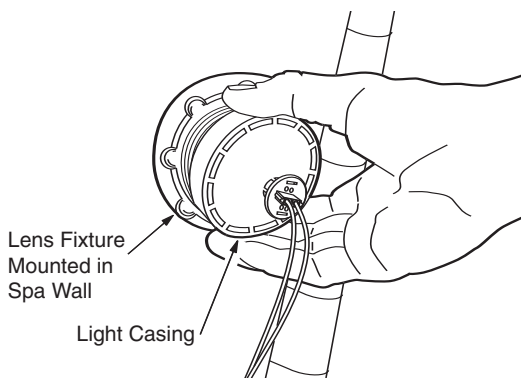

3. Remove existing spa bulb.

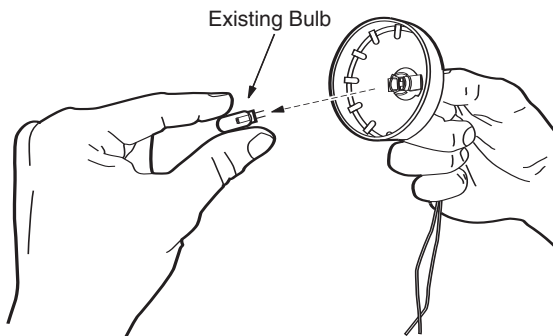

4. Plug D'Light into wedge socket.

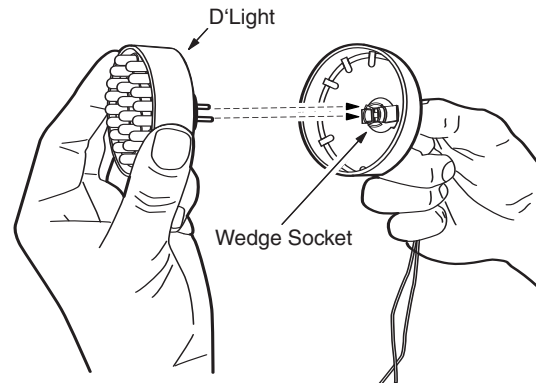

5. To test light, turn on power. Start and stop the color cycle several times.
6. Turn off power. Reinstall light casing onto back of lens fixture.

Operation

The Polaris D'Light provides digital color using high-intensity, multi-color LEDs.

Two modes of operation are available:

Color Fade:

Light moves slowly through the color sequence.

Color Hold:

Light displays just one color.

To place unit on Color Hold:

- Turn on power to the D'Light and wait until the desired color is displayed.
- Turn off power for approximately three (3) seconds, not more than six (6), then turn power back on. The light will display the chosen color without change.

To restart color changes, turn off power for at least six (6) seconds, then turn on power.



2620 Commerce Way, Vista, CA 92081-8438 • 760-599-9600 • 1-800-822-7933 • www.polarispool.com